

Let's take a tour of the new library and community space!

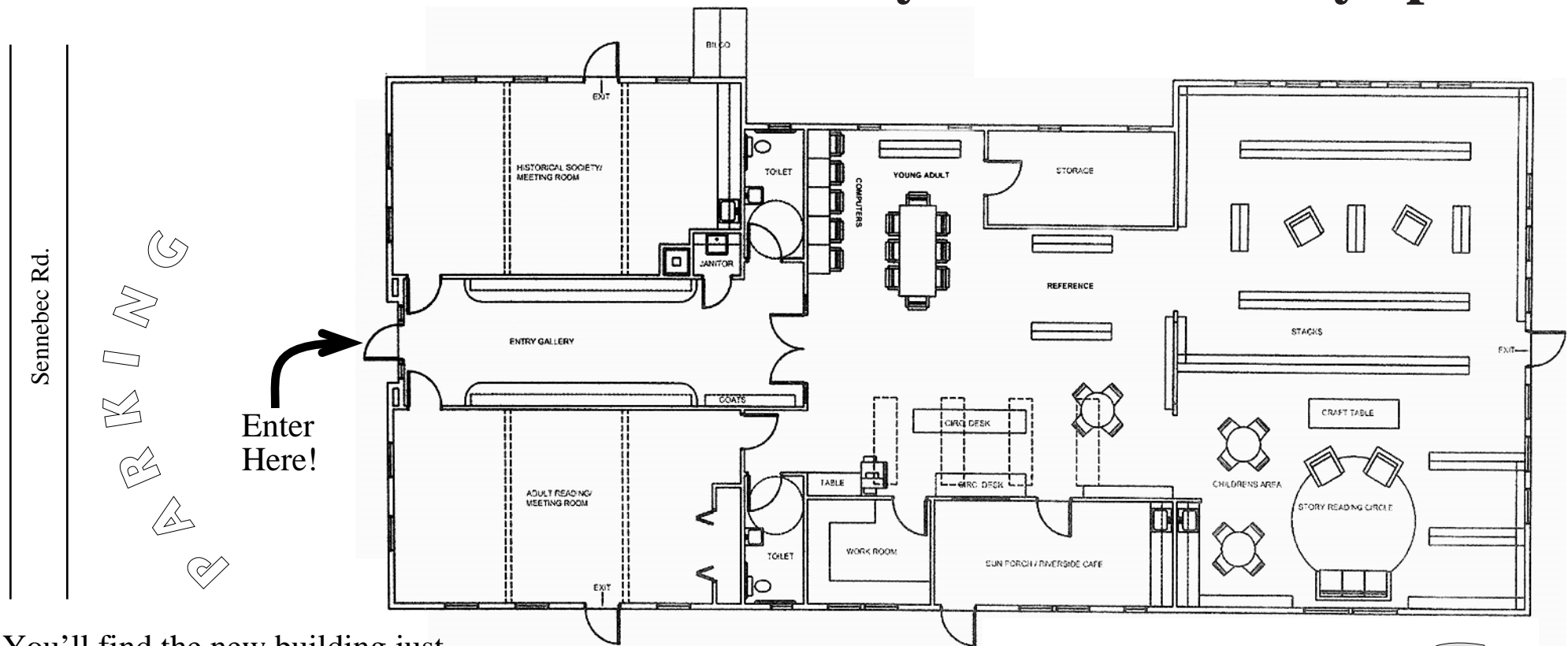

You'll find the new building just uphill from the Children's Garden and across Sennebec Road from the Town Office. From the front, the building resembles a lovely old Cape. Once you've parked your car, you'll go through the wheel-chair accessible front door into an entry gallery, where periodically the work of area artists, photographers, and others will be hung.

To the left of the entrance is the home of the Appleton Historical Society—a spacious room with ample storage space for historical documents and photographs, shelves for genealogical and reference materials, and a work table for doing research. In addition to being the space for Society meetings, the room will be available to residents for meetings and other gatherings. Thanks to a very generous donation from the Sukeforth and Pease families, the room will be named in memory of Gwendolyn Sukeforth and Ruth Pease.

To the right of the entrance is another spacious room, designed to be used as a reading room when the library is open. It will also house the library's periodicals. Particularly exciting about this room is that it will be available for meetings, lectures, readings, films, and other events for the community. It has the capacity for about 50 chairs and will be in use year round.

At the end of the entry gallery, to the left, is a full washroom that will be available during non-library hours.

These two rooms—both of which have six large windows for lots of natural light—and the entry gallery and bathroom fill the entire front "house" part of the building.

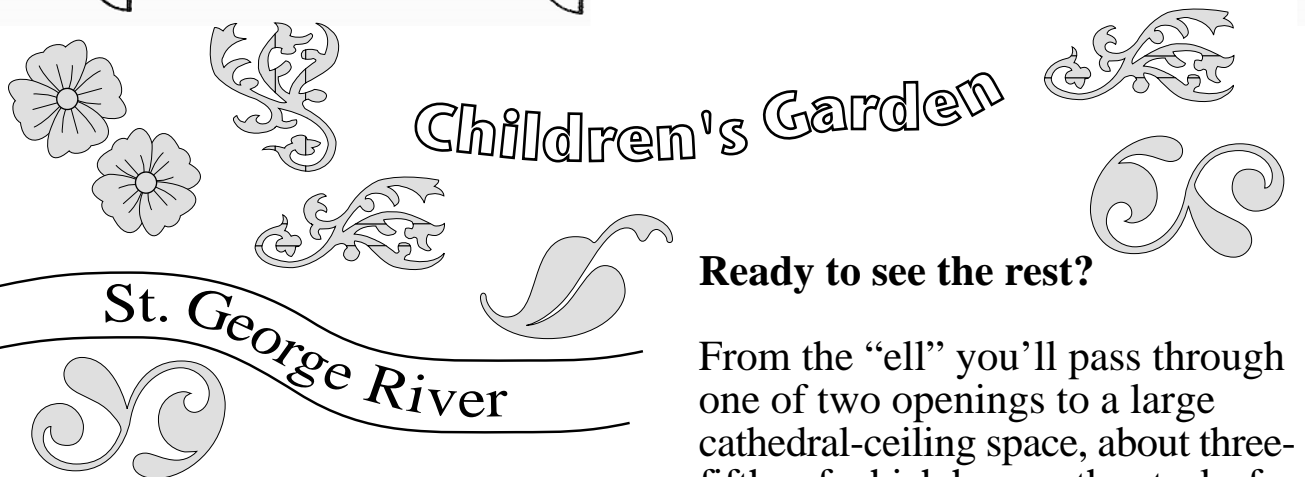

Let's move on!

At the end of the gallery, a door gives on to the main part of the library, a space which forms an ell between the "house" and "barn." Go on in! To the left you'll see the computer area, which is designed to have 4-6 carrels for computers with internet access and one designated computer available to patrons to search the library catalog. Beyond the computers, also on the left, is the Young Adult area, with ample bookshelves for our YA collection and a table and chairs for doing homework and research.

In the center of the main room you'll see several shelves devoted to the reference collection—dictionaries, encyclopedias, and other materials—and another table and chairs nearby. The circulation desk is on the south wall, and adjacent to it a copy center, a combined workroom and librarian's office, and a second full washroom. A door to the left of the circulation desk leads to a sun porch and the Riverside Café, where library patrons and others may enjoy a cup of coffee and conversation overlooking the lovely Children's Garden and the St. George River. A door to the outside from the sun porch invites a stroll through the garden or peaceful moments by the river.

Ready to see the rest?

From the "ell" you'll pass through one of two openings to a large cathedral-ceiling space, about three-fifths of which houses the stacks for adult fiction, non-fiction, and biography, with shelves dedicated to new acquisitions and the selections for the Appleton Book Group. The area will include another large table and chairs for use by patrons.

The other two-fifths of this space will be home to a wonderfully sun-lit children's area, with a story circle, tables and chairs for crafts and snacks, a counter and sink for washing up, and expanded shelf space for our ever-growing collection of picture books, chapter books, and junior fiction and non-fiction. One rank of shelves will provide a head-height wall of sorts separating the children's area from the adult stacks.

In addition to several large windows at normal height and an emergency exit, this rear structure will have a row of seven "clerestory" windows across the back that will provide abundant natural light for the whole area.

Well, our tour is over. We hope you've enjoyed it. You may find that, with our terrific and expanding collection of books, well-designed lighting and ample natural light, radiant-floor heat, computer availability, and lots of space and comfortable reading areas, you may just want to stay!